

**Schedule 12
Part A
Regulation 33, 34
Premises licence**

Premises licence number

MVDC265/2

Part 1 – Premises details

Postal address of premises, or if none, ordnance survey map reference or description

**Scarlett Arms
Walliswood**

Post town **Ockley**

Post code **RH5 5RD**

Telephone number **01306 627243**

Where the licence is time limited the dates

Licensable activities authorised by the licence

Films, Live Music, Recorded Music, Performance of Dance, Provision of entertainment facilities for Making Music and Dancing, Late night refreshment and Alcohol sales.

The times the licence authorises the carrying out of licensable activities

Films, Recorded Music, Performance of Dance, Provision of entertainment facilities for Making Music and Dancing, Late night refreshment

Monday to Sunday 10:00 to 00:30

From 10:00 on New Year's Eve until 10:00 on 1st January each year.

Performance of Dance and Live Music

Monday to Sunday 10:00 to 00:00

From 10:00 on New Year's Eve until 10:00 on 1st January each year.

Alcohol sales

Monday to Sunday 10:00 to 00:00

From 10:00 on New Year's Eve until 10:00 on 1st January each year.

The opening hours of the premises

Monday to Sunday 10:00 to 00:30

From 10:00 on New Year's Eve until 10:00 on 1st January each year.

Where the licence authorises supplies of alcohol whether these are on and / or off supplies

On and off supplies

Part 2

Name, (registered) address, telephone number and email (where relevant) of holder of premises licence

**Hall and Woodhouse Limited
The Brewery
Blandford St. Mary
Dorset
DT11 9LS**

Registered number of holder, for example company number, charity number (where applicable)

57696

Name, address and telephone number of designated premises supervisor where the premises licence authorises for the supply of alcohol

**Tracey Jane Wilson
The Scarlett Arms
Walliswood
Ockley
Dorking
Surrey
RH5 5RD**

Personal licence number and issuing authority of personal licence held by designated premises supervisor where the premises licence authorises for the supply of alcohol

LN/3025 – Waverley Borough Council

Date of Issue **9th July 2007**

.....
Environmental Health Manager

Annex 1 – Mandatory conditions

- (1) No supply of alcohol may be made under the premises licence -
 - (a) at a time when there is no designated premises supervisor in respect of the premises licence, or
 - (b) at a time when the designated supervisor does not hold a personal licence or his personal licence has been suspended.
- (2) Every supply of alcohol under the premises licence must be made or authorised by a person who holds a personal licence.

Mandatory condition: exhibition of films

- (1) Where the film classification body is specified in the licence, unless subsection (3)(b) applies, admission of children must be restricted in accordance with any recommendation made by that body.
- (2) Where -
 - (a) the film classification body is not specified in the licence, or
 - (b) the relevant licensing authority has notified the holder of the licence that this subsection applies to the film in question,admission of children must be restricted in accordance with any recommendation made by that licensing authority.
- (3) In this section -
 - "children" means persons aged under 18; and
 - "film classification body" means the person or persons designated as the authority under section 4 of the Video Recordings Act 1984 (c.39) (authority to determine suitability of video works for classification).

Mandatory Licensing Conditions from the 6th April 2010

- 1. (1) The responsible person shall take all reasonable steps to ensure that staff on relevant premises do not carry out, arrange or participate in any irresponsible promotions in relation to the premises.
 - (2) In this paragraph, an irresponsible promotion means any one or more of the following activities, or substantially similar activities, carried on for the purpose of encouraging the sale or supply of alcohol for consumption on the premises in a manner which carries a significant risk of leading or contributing to crime and disorder, prejudice to public safety, public nuisance, or harm to children—
 - (a) games or other activities which require or encourage, or are designed to require or encourage, individuals to—
 - (i) drink a quantity of alcohol within a time limit (other than to drink alcohol sold or supplied on the premises before the cessation of the period in which the responsible person is authorised to sell or supply alcohol), or
 - (ii) drink as much alcohol as possible (whether within a time limit or otherwise);
 - (b) provision of unlimited or unspecified quantities of alcohol free or for a fixed or discounted fee to the public or to a group defined by a particular characteristic (other than any promotion or discount available to an individual in respect of alcohol for consumption at a table meal, as defined in section 159 of the Act);
 - (c) provision of free or discounted alcohol or any other thing as a prize to encourage or reward the purchase and consumption of alcohol over a period of 24 hours or less;

- (d) provision of free or discounted alcohol in relation to the viewing on the premises of a sporting event, where that provision is dependent on–
 - (i) the outcome of a race, competition or other event or process, or
 - (ii) the likelihood of anything occurring or not occurring;
 - (e) selling or supplying alcohol in association with promotional posters or flyers on, or in the vicinity of, the premises which can reasonably be considered to condone, encourage or glamorise anti-social behaviour or to refer to the effects of drunkenness in any favourable manner.
2. The responsible person shall ensure that no alcohol is dispensed directly by one person into the mouth of another (other than where that other person is unable to drink without assistance by reason of a disability).
 3. The responsible person shall ensure that free tap water is provided on request to customers where it is reasonably available.

Mandatory Conditions from the 1st October 2010

4. (1) The premises licence holder or club premises certificate holder shall ensure that an age verification policy applies to the premises in relation to the sale or supply of alcohol.
(2) The policy must require individuals who appear to the responsible person to be under 18 years of age (or such older age as may be specified in the policy) to produce on request, before being served alcohol, identification bearing their photograph, date of birth and a holographic mark.
5. The responsible person shall ensure that–
 - (a) where any of the following alcoholic drinks is sold or supplied for consumption on the premises (other than alcoholic drinks sold or supplied having been made up in advance ready for sale or supply in a securely closed container) it is available to customers in the following measures–
 - (i) beer or cider: ½ pint;
 - (ii) gin, rum, vodka or whisky: 25 ml or 35 ml; and
 - (iii) still wine in a glass: 125 ml; and
 - (b) customers are made aware of the availability of these measures.

Annex 2 – Conditions consistent with operating schedule

GENERAL - ALL FOUR LICENSING OBJECTIVES

The Licence will be subject to the mandatory conditions.

THE PREVENTION OF CRIME AND DISORDER

None

PUBLIC SAFETY

None

THE PREVENTION OF PUBLIC NUISANCE

All performances of recorded and live music involving amplification will be monitored and kept to such a level as not to cause a nuisance to the occupiers of any noise sensitive premises in the locality.

THE PROTECTION OF CHILDREN FROM HARM

The premises shall operate a "Proof of Age" scheme of such type that may be approved by the Police from time to time.

Annex 3 – Conditions attached after a hearing by the licensing authority

None

Annex 4 – Plans



CIVIC CONSULTANTS
 1000 Highway 101, Suite 100
 Victoria, BC V8V 2G2
 Phone: (250) 383-1111
 Fax: (250) 383-1112
 Email: info@civicconsultants.com
 Website: www.civicconsultants.com
 Project: HALL & WOODHOUSE
 Drawing Title: FLOOR LAYOUT
 Drawing No.: 100000000
 Scale: 1:200 (A3) | Date: 01.2007
 Project No.: 2006 | Drawing No.: 1

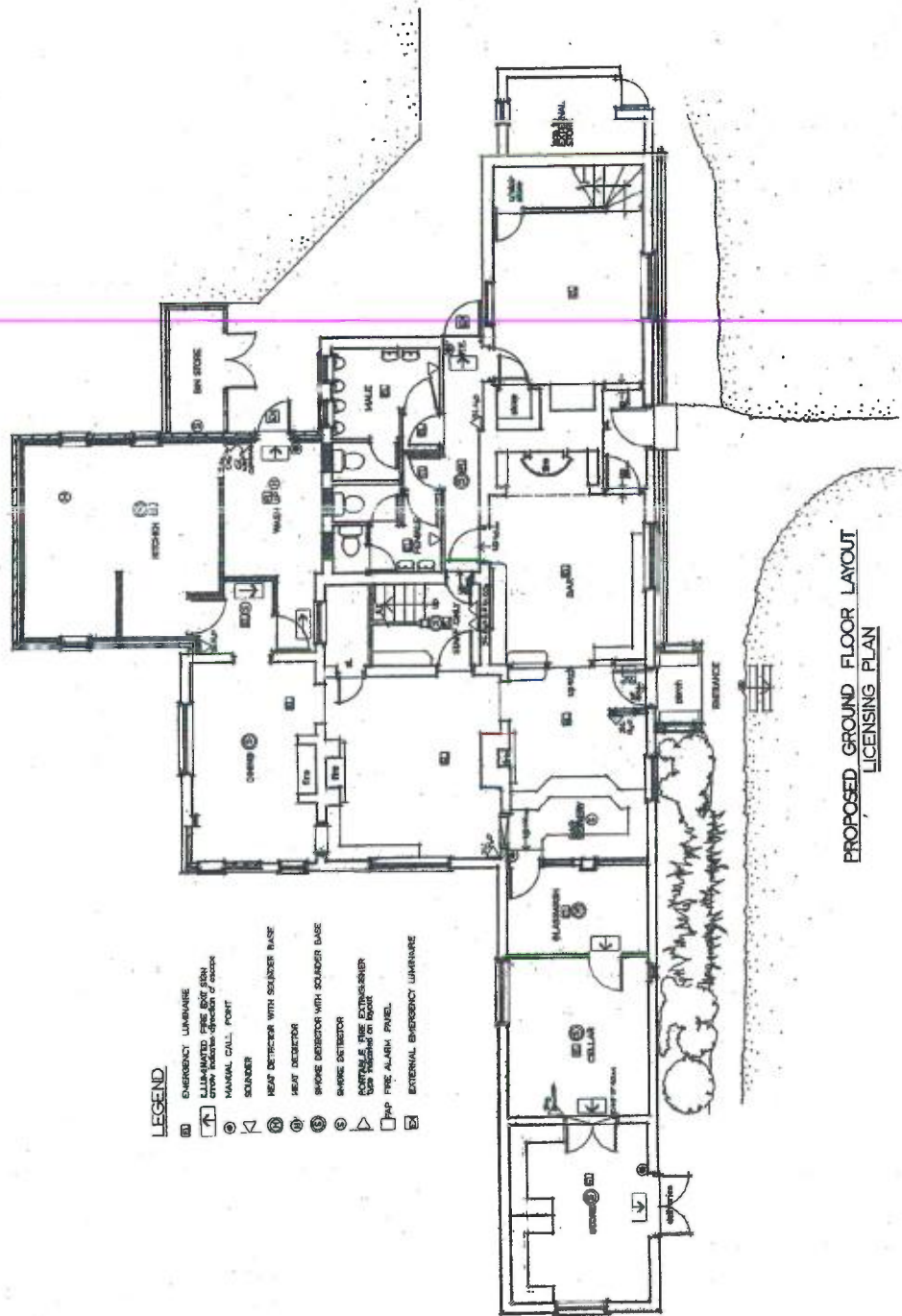

- LEGEND**
- ① EMERGENCY LUMINAIRE
 - ② ILLUMINATED FIRE EXIT SIGN
arrow indicates direction of escape
 - ③ MANUAL CALL POINT
 - ④ SOUNDER
 - ⑤ HEAT DETECTOR WITH SOUNDER BASE
 - ⑥ HEAT DETECTOR
 - ⑦ SMOKE DETECTOR WITH SOUNDER BASE
 - ⑧ SMOKE DETECTOR
 - ⑨ FIRE ALARM CONTROL PANEL
 - ⑩ EXTERNAL EMERGENCY LUMINAIRE

PROPOSED GROUND FLOOR LAYOUT
LICENSING PLAN

