

IMPORTANT NOTES:

NO SURVEY HAS BEEN UNDERTAKEN,
CONTRACTOR TO CARRY OUT OWN SURVEY
TO ASCERTAIN DIMENSIONS, LEVELS, &
GENERAL CONSTRAINTS PRIOR TO
MANUFACTURE. ADJUST DIMS / DESIGN
ACCORDINGLY.
ALL REFRIGERATED EQUIPMENT TO HAVE
Min. 25mm AIR GAP ON ALL SIDES.

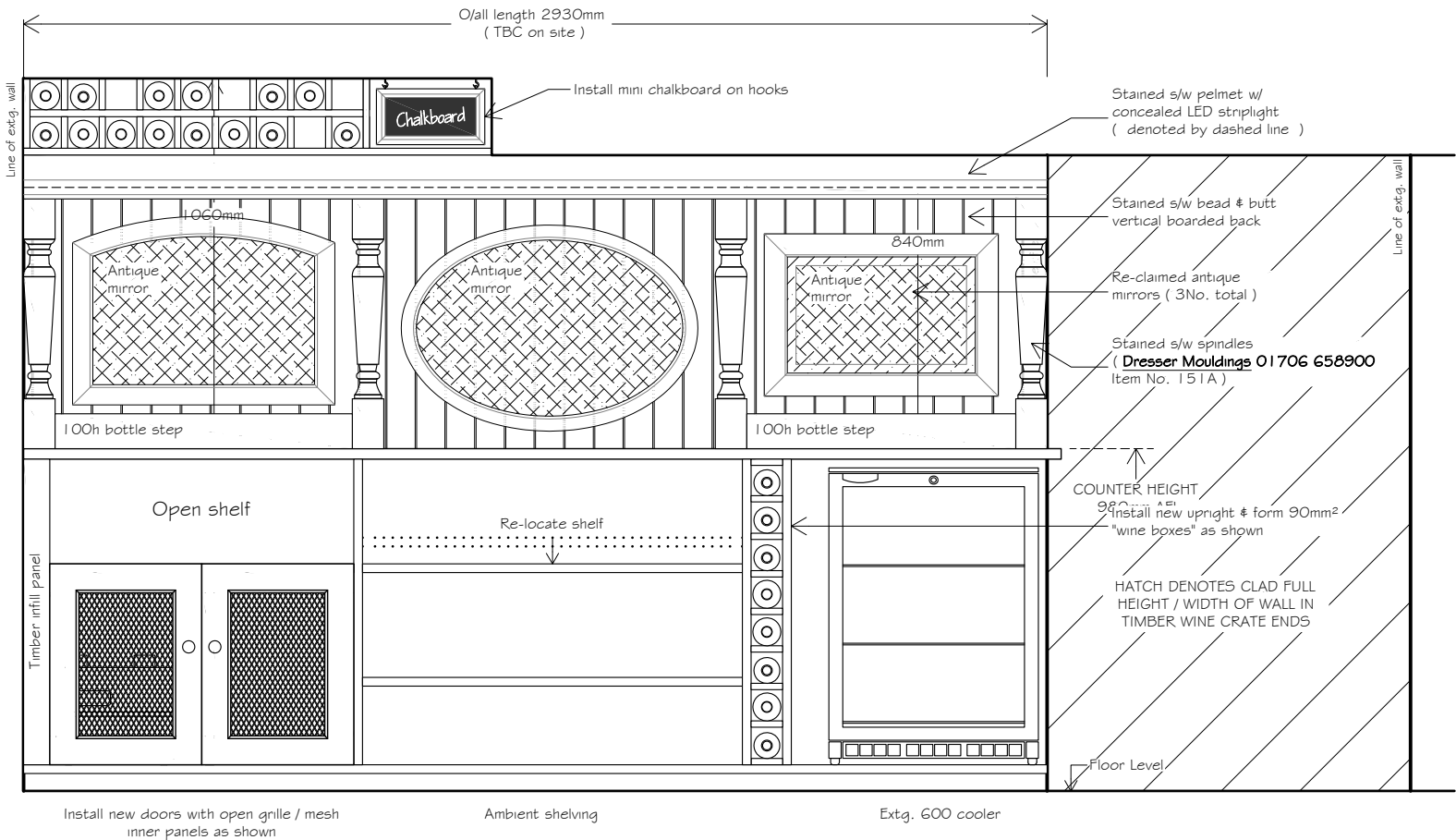

BACKFITTING ELEVATION AS PROPOSED

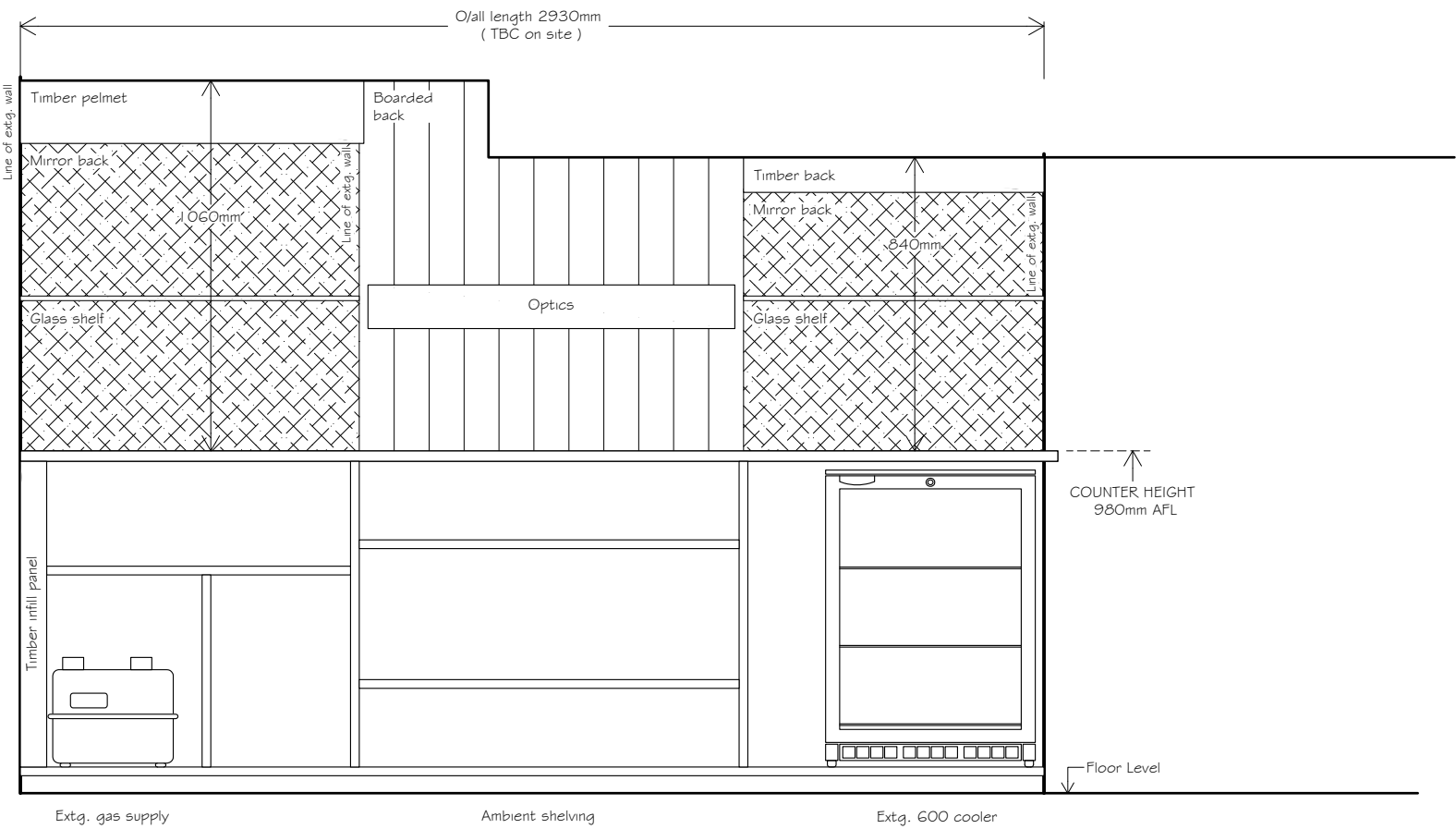

BACKFITTING ELEVATION AS EXISTING

DO NOT SCALE FROM THIS DRAWING

GREENLINE DESIGN Ltd.

Design Consultants

gwjdesign@icloud.com

110 High Street, Hampton in Arden, Solihull, B92 0AD

Tel: 07711 879591

Client: HALL & WOODHOUSE

Project: THE SNOWDROP INN, RH16 2QE

Drawing: BACKFITTING ELEVATION;
AS EXISTING & AS PROPOSED

Scale: 1: 20 @ A3

Date: 01.17

Project: F1661

Drg No. 10

This Drawing is the property of **GREENLINE DESIGN LTD.** Copyright is reserved by them, and the drawing is issued strictly on the condition that it shall NOT be copied, in whole or in part, without the prior written consent of **GREENLINE DESIGN LTD.**
ALL DIMENSIONS TO BE CHECKED ON SITE prior to the commencement of work.
Any discrepancies to be reported to the Supervising Officer.