

NOTE:

The Contractor is to check and verify all building and site dimensions, levels and sewer invert levels at connection points before work starts.

This drawing must be read with and checked against any structural or other specialist drawings provided.

The Contractor is to comply in all respects with the current Building Regulations whether or not specifically stated on these drawings.

This drawing is not intended to show details of foundation or ground conditions. Each area of ground relied upon to support the structure depicted must be investigated by the Contractor and suitable methods of foundation be provided.

- LEGEND**
- FD** Fire Rated Doorset
- Features and Fixings**
- Cigarette Vending Machine
 - Telephone
 - Games Machine (AWP or SWP)
 - Pool Table
- Services**
- Fire Alarm Panel
 - Automatic fire detector
 - Manual Call Point
 - Sounder
 - Sounder Beacon
 - Emergency light fitting (Fluorescent, Downlight or Luminaire)
 - Emergency Exit Light c/w legend (directional)
 - 1 litre water fire extinguisher
 - Dry powder fire extinguisher
 - Carbon Dioxide fire extinguisher
 - Foam fire extinguisher
 - CCTV camera
 - Mechanical extraction fan
 - Air conditioning unit

No.	By	Date

Client	Hall & Woodhouse
Room no.	4024
Site	The Jekyll & Hyde PH Turgis Green Basingstoke
Title	Ground Floor Layout Licensing

Effective Drinking Area=	170.3 sq.m.						
Project Manager/ Designer	MCH	Drawn By	AR	Scale	1:100@A3	Date	28/05/05
Arch./Des.	ROSE	Drawing Number	6072/4024/01				

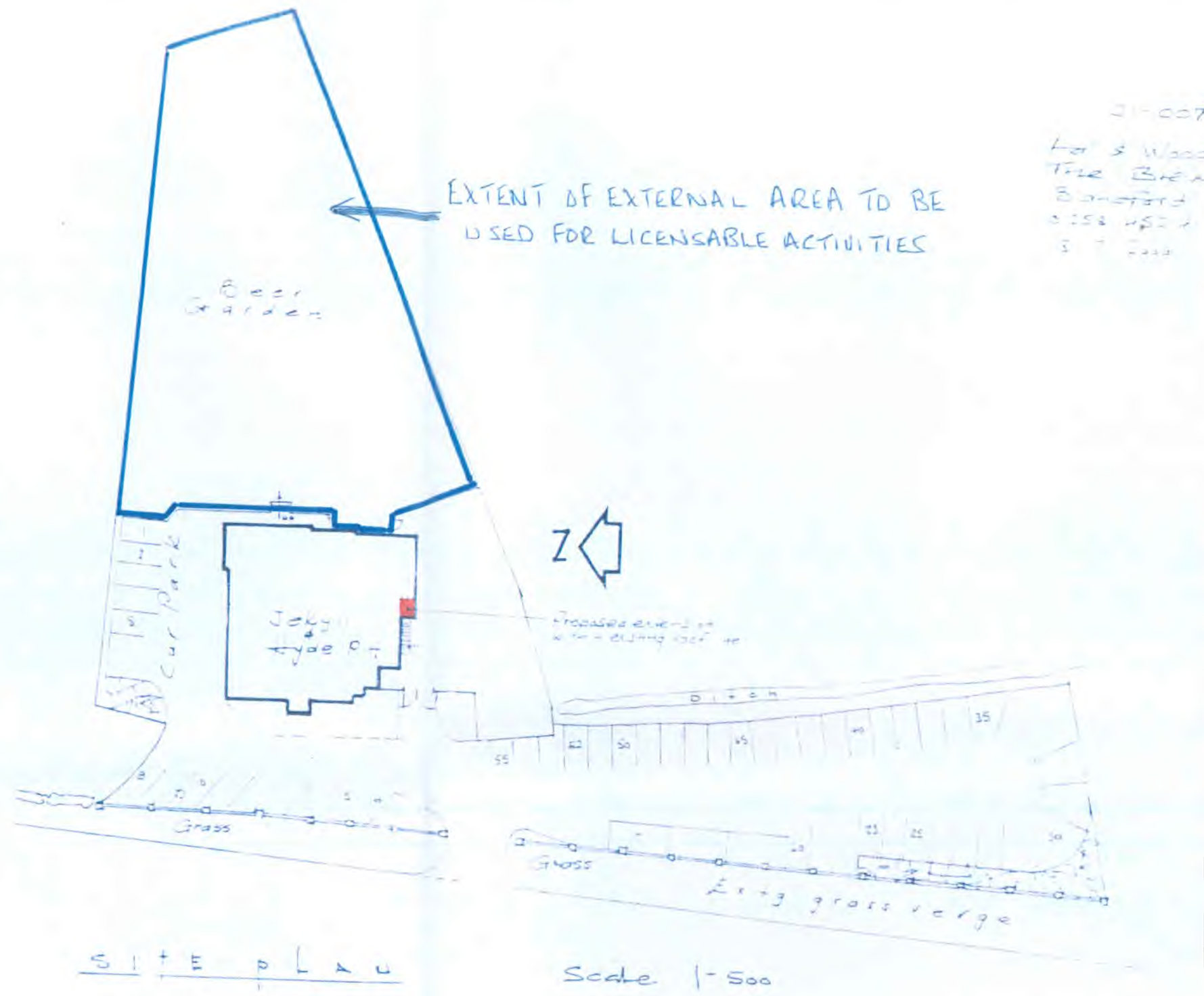
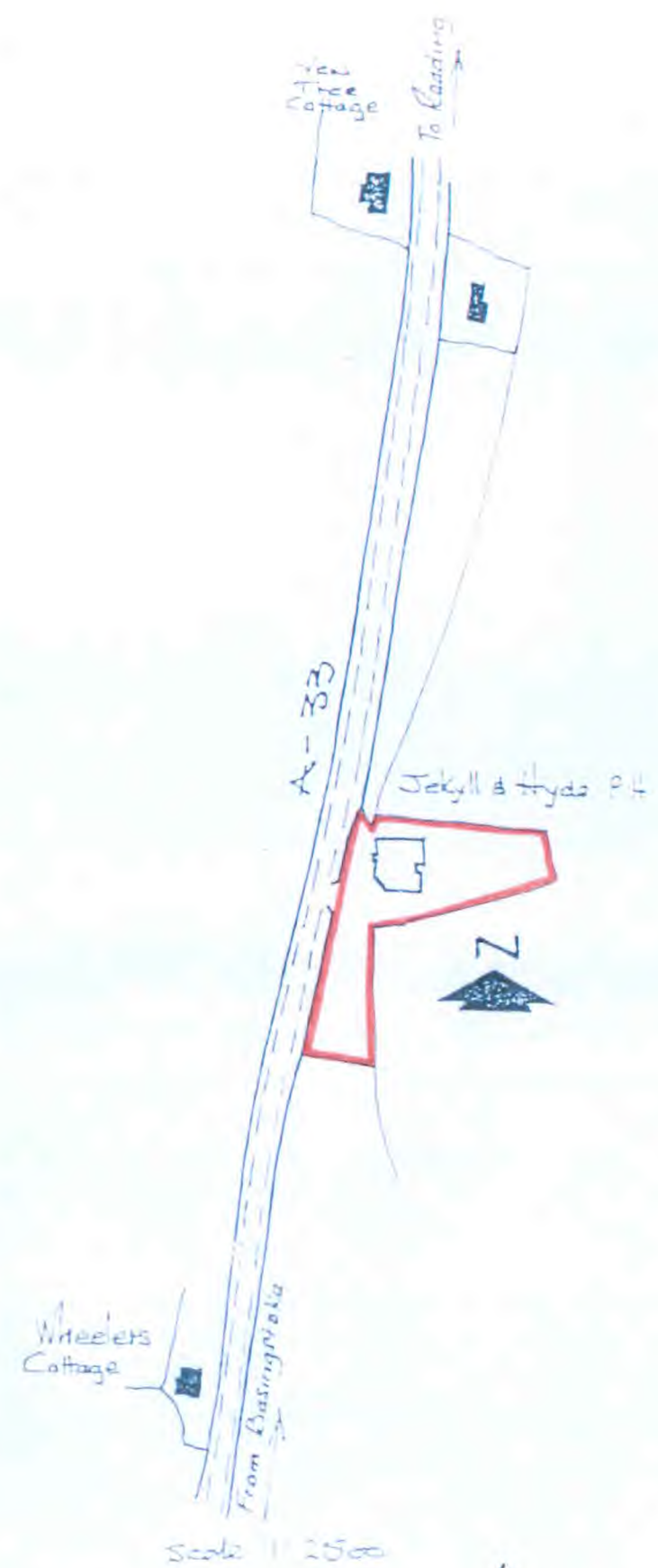

21-007
 Lot 3 Woodhouse and
 The Brewery
 Banford
 258 452 2
 3 7 2000

LOCATION OF JECKYLL & HYDE
 TURGIS GREEN.

PRELIM PLAN

11/06/20/PRM MV