

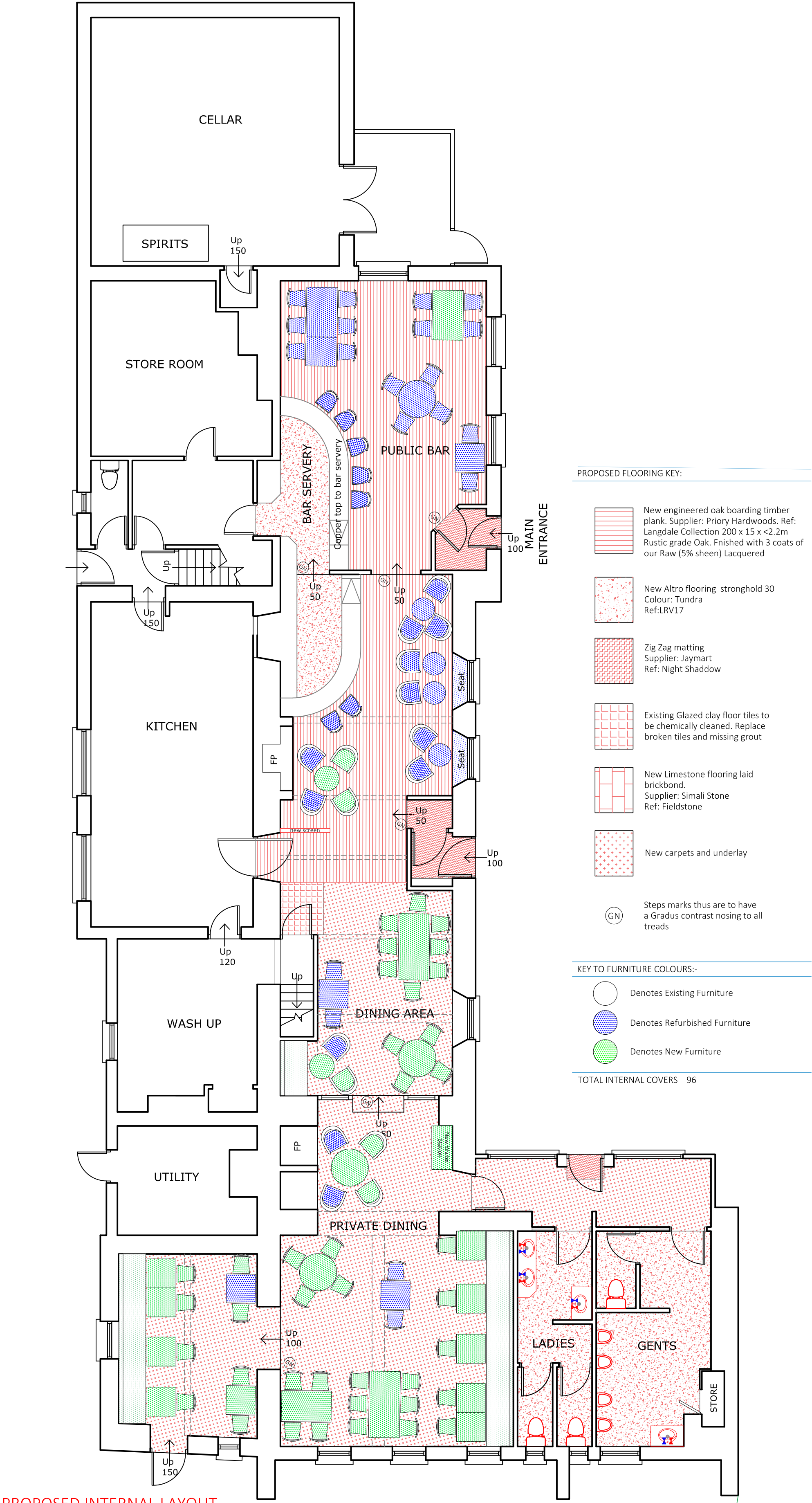

EXISTING INTERNAL LAYOUT



PROPOSED INTERNAL LAYOUT

TOILETS:

- Allow to rip out all fixtures, fittings and sanitary ware
- Allow for replacing all floor coverings with new altro flooring 22m2
- Allow for half height tiles throughout both toilets
- Replace all sanitary ware as indicated
- Form a double width vanity unit within ladies and a single vanity unit in gents.
- Decorations to all painted surfaces, Incl. doors and windows.
- Allow for alteration to M&E. Including replacing 8no light fittings
- Overhaul all windows and doors to ensure they function correctly. Allow for replacing ironmongery

BAR AREA:

- Allow for replacing carpet and underlay 18m2
- Allow for replacing carpet with timber plank 49m2
- Allow for chemical clean to Ceramic tile flooring 4m2
- Allow for 1.8m of fixed seating
- Sandblast all dado height panelling
- Sandblast timber beams
- Decorations to all painted surfaces, Incl. doors and windows.
- Allow for alteration to M&E. Including replacing 15no light fittings 5no new light fittings and terminating 4no light fittings.
- Overhaul all windows and doors to ensure they function correctly. Allow for replacing ironmongery
- Allow for timber screen to side of kitchen swing door

BAR SERVERY & CORRIDORS:

- Allow for replacing carpet and underlay 9m2
- Allow for Replacing altro flooring 8m2
- Allow to replace entrance matting with zigzag 6m2
- Sandblast all dado height panelling
- Decorations to all painted surfaces, Incl. doors and windows.
- Allow to wrap section of bar top with copper.
- Allow to polish existing copper bar servery top.
- Allow for alteration to M&E. Including replacing 5no light fittings and 5no new light fittings
- Overhaul all windows and doors to ensure they function correctly. Allow for replacing ironmongery

PRIVATE & DINING AREAS:

- Allow for replacing carpet and underlay 55m2
- Allow for 9.5m of fixed seating
- Sandblast all dado height panelling
- Sandblast all timber beams
- Decorations to all painted surfaces, Incl. doors and windows.
- Allow for alteration to M&E. Including replacing 9no light fittings ,1no new light fittings and terminating 2no light fittings
- Overhaul all windows and doors to ensure they function correctly. Allow for replacing ironmongery
- Allow to overhaul feature fireplace to include additional lighting

-	-	-	Project Title:		
B	Revised drawings following H&W Ops teams comments	20-11-25	The Silent Woman, Wareham		
A	Revised drawings following H&W Ops teams comments	13-11-25	Internal Refurbishment & Extension Scheme		
Rev :	Note :	Date :	Drawing Title:		
			EXISTING & PROPOSED INTERNAL LAYOUT		
<div>1.1 THIS INFORMATION IS NOT INTENDED TO PROVIDE A FULL SPECIFICATION OF WORKS &amp; SHOULD BE READ IN CONJUNCTION WITH A SURVEY, SCHEME DRAWINGS &amp; TENDER DOCUMENT.</div> <div>1.2 ALL WORKS TO COMPLY WITH CURRENT BUILDING REGULATIONS &amp; LOCAL AUTHORITY REQUIREMENTS.</div> <div>1.3 ELECTRICAL INSTALLATIONS MUST COMPLY WITH IEE 18TH EDITION REGULATIONS FOR THE ELECTRICAL EQUIPMENT OF BUILDINGS &amp; WORKMANSHIP.</div> <div>1.4 DIMENSIONS TO BE CHECKED ON SITE.</div> <div>1.5 ANY FURTHER INFORMATION OR QUERIES ARISING FROM THIS DRAWING SHOULD BE ADDRESSED TO 2C design</div>			Project Address:		Rev:
			Bere Road		B
			Wareham		
			BH20 7PA		20.10.25
			Drawing Number:		Sheet No
			2CD51027		1 of 1
			Paper Size:		A1
			Scale UOS:		1:75
			<div>2C Design Consultants Ltd</div> <div>7 Edison Buildings</div> <div>Cowenry, CV1 4JA</div> <div>tel: 02476-995-400</div> <div>www.2Cdesign.co.uk</div>		